

## **INSTRUCTIONS FOR FILING COVENANT AND AGREEMENT FORMS**

1. Provide 8.5" x 11" Plot Plan showing location and size of all stormwater Best Management Practices (BMPs) – Exhibit 1.
2. Fill out, in **BLACK INK ONLY**, one copy of the Covenant and Agreement Form.
3. Property owner(s) must print and sign their name(s) – **SIGNATURE(S) MUST BE NOTARIZED.**
4. Submit the completed Covenant & Agreement (C&A) Form to Bureau of Sanitation for review. Upon approval, Bureau of Sanitation will provide Operation and Maintenance (O&M) Plan(s) and sign the Covenant and Agreement.
5. Record the C&A Form and the O&M Plan with the Los Angeles County Registrar-Recorder and obtain a certified copy. County Recorder located at:
  - 1) 12400 Imperial Highway  
Norwalk, CA 90650  
(Near the intersection of the 5 and 605 freeways)
  - 2) 14340 Sylvan Street  
Van Nuys, CA 91401  
(Near Van Nuys City Hall)
  - 3) 11701 S. La Cienega Blvd., 6<sup>th</sup> Floor  
Los Angeles, CA 90045  
(LAX Courthouse)
6. Return the certified copy of the recorded form to the Bureau of Sanitation requiring the covenant (should be a purple stamp on the back of the last page of document recorded).

**NO FINAL APPROVAL/CLEARANCE WILL BE GRANTED WITHOUT BUREAU OF SANITATION RECEIPT OF THE CERTIFIED COPY OF THE C&A, PLOT PLAN AND O&M PLAN.**

Recording requested by and mail to:

Name: \_\_\_\_\_

Address: \_\_\_\_\_

\_\_\_\_\_

\_\_\_\_\_

\*\*\*\*\* Space Above This Line For Recorder's Use \*\*\*\*\*

**MASTER COVENANT AND AGREEMENT**  
REGARDING ON-SITE STORMWATER MITIGATION MEASURES AND MAINTENANCE

I (We), the undersigned, hereby certify that I am (we are) the owner(s) of the hereinafter legally described real property ("Property") located in the City of Los Angeles, County of Los Angeles, State of California (please give the legal description):

LEGAL DESCRIPTION

ASSESSOR'S ID# \_\_\_\_\_ TRACT NO. \_\_\_\_\_ BLOCK NO. \_\_\_\_\_ LOT NO \_\_\_\_\_

Site Address \_\_\_\_\_

In consideration of the City of Los Angeles allowing \_\_\_\_\_ development on said Property, I (we) do hereby covenant and agree to install, operate and maintain in a good operable condition at all times, at my (our) sole cost, all on-site stormwater Best Management Practices (BMPs) per approved plans. The location and type of each BMP feature installed on the Subject Property is identified on the site diagram attached hereto as Exhibit 1. I (we) shall maintain, in accordance with the attached Operation & Maintenance Plan (Attachment 1), the following on-site stormwater BMPs:

- Rain Tank (min 55 gal): # of barrels \_\_\_\_\_; \_\_\_\_\_ total gallons, with minimum of \_\_\_\_\_ Sq. Ft of vegetated landscaping
- Rain Tank / Cistern: # of tanks / cistern \_\_\_\_\_; \_\_\_\_\_ total gallons, with minimum of \_\_\_\_\_ Sq. Ft of vegetated landscaping
- Porous pavement/pavers: \_\_\_\_\_ Sq. Ft (for incidental rainfall); and / or \_\_\_\_\_ Sq. Ft. with \_\_\_\_\_ ft sub base
- Rain Garden (lined): # of rain gardens \_\_\_\_\_; \_\_\_\_\_ total Sq. Ft.       Dry Well: \_\_\_\_\_ Cu. Ft.
- Rain Garden (unlined): # of rain gardens \_\_\_\_\_; \_\_\_\_\_ total Sq. Ft.       Infiltration Trench: \_\_\_\_\_ Cu. Ft.
- Flow Thru Planter: # of planters \_\_\_\_\_; \_\_\_\_\_ total Sq. Ft.       Green Roof: \_\_\_\_\_ Sq. Ft.
- Other: \_\_\_\_\_

Owner further covenants and agrees that the above-described stormwater device(s) shall not be removed from the Subject Property unless a revised Plan is approved by the Bureau of Sanitation. In the event that any portion of the above-specified on-site stormwater pollution removal device(s) or BMPs is modified, I (we) shall immediately provide the Bureau of Sanitation of the City of Los Angeles with a revised Plan for their approval, and sign and record a Supplemental Covenant and Agreement, specifying all of the on-site stormwater pollution removal device(s) and BMPs, as modified (along with a modified O&M Plan). No Supplemental Covenant and Agreement shall, in any way, limit or diminish my (our) General Maintenance Obligation.

This Master Covenant and Agreement, and all obligations herein, shall run with the Property and shall be binding upon any future owners, encumbrancers, their successors, heirs or assigns and shall continue in effect until the Bureau of Sanitation approves the termination hereof.

Owner further covenants and agrees that if Owner hereafter sells the Subject Property, Owner shall provide printed educational materials to the buyer regarding the stormwater device(s) that are located on the Subject Property, including the type(s) and location(s) of all such devices, and instructions for properly maintaining all such devices.

\_\_\_\_\_  
(Print Name of Property Owner)

\_\_\_\_\_  
(Print Name of Property Owner)

\_\_\_\_\_  
(Signature of Property Owner)

\_\_\_\_\_  
(Signature of Property Owner)

Dated this \_\_\_\_\_ day of \_\_\_\_\_ 20\_\_\_\_.

Dated this \_\_\_\_\_ day of \_\_\_\_\_ 20\_\_\_\_.

**(PLEASE ATTACH NOTARY ACKNOWLEDGEMENT)**

\*\*\*\*\* Space Below This Line For Bureau Internal Use \*\*\*\*\*

Permit No. \_\_\_\_\_

Approved for recording by: Department of Public Works, Bureau of Sanitation

\_\_\_\_\_  
(Print Name) Engineering Associate

\_\_\_\_\_  
(Signature)

Date: \_\_\_\_\_

PLOT PLAN  
SITE ADDRESS  
PCIS #

SAMPLE

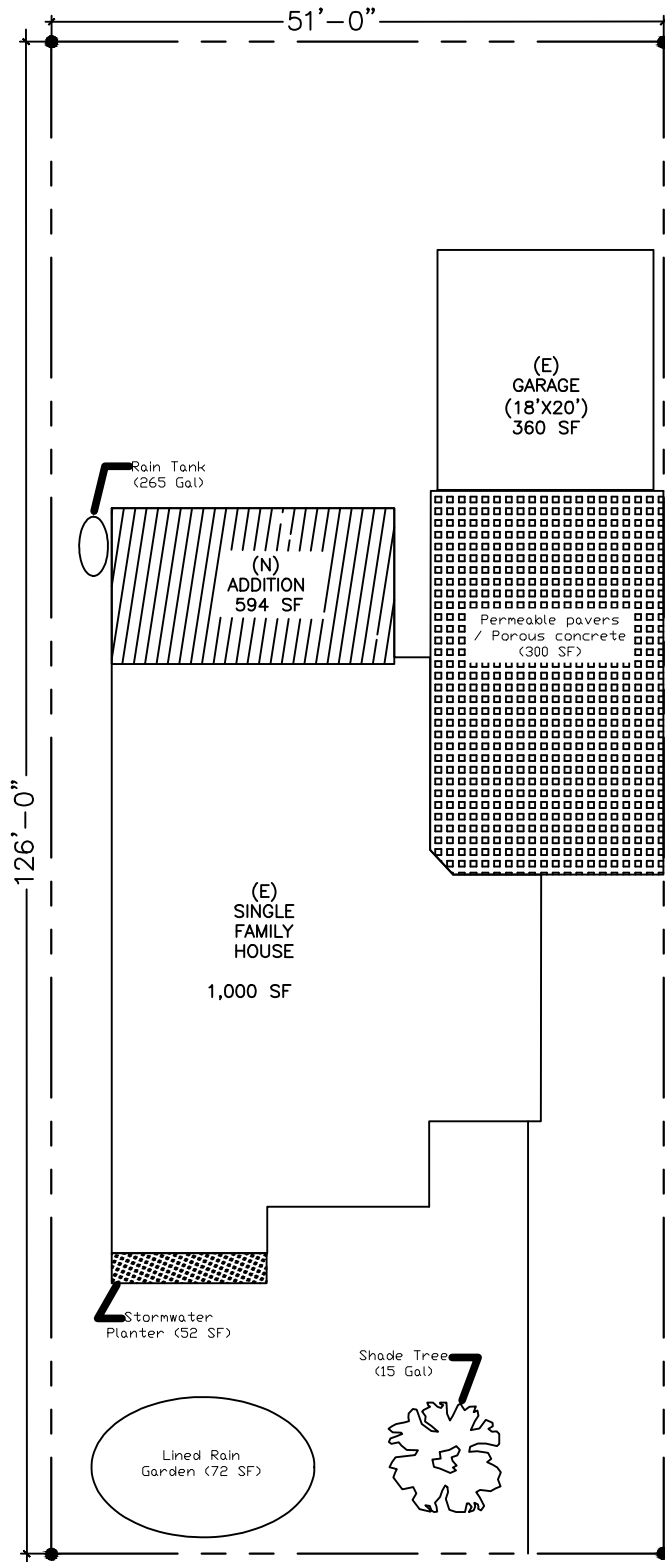

LID SUMMARY OF BMPS:

- 1 - 265 GAL RAIN TANK
- 1 - STORMWATER PLANTER (52 SF)
- 1 - LINED RAIN GARDEN (72 SF)
- 1 - SHADE TREE (15 GAL MIN)
- 300 SF OF PERMEABLE PAVERS (INCIDENTAL)

CL HAUSER AVENUE

SAMPLE